

EMI Connector-Seal

Spira's EMI-only Connector-Seal gaskets are designed to provide an EMI seal in flange-mounted connectors for the life of a system. These gaskets are extremely durable, and have achieved up to 1,000 insertions in actual use.

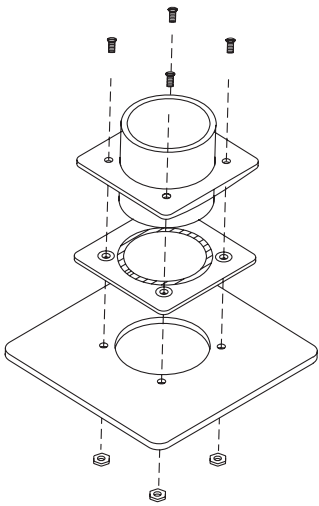
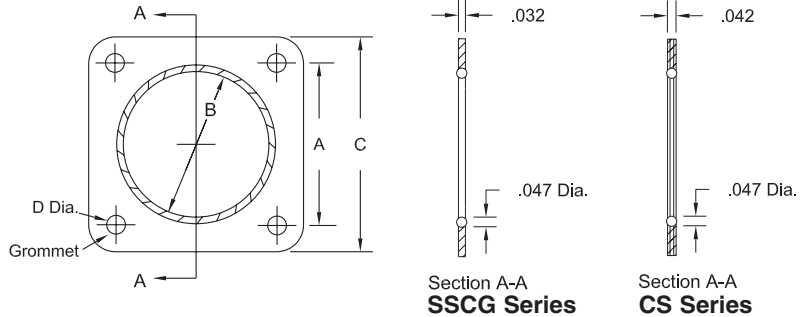
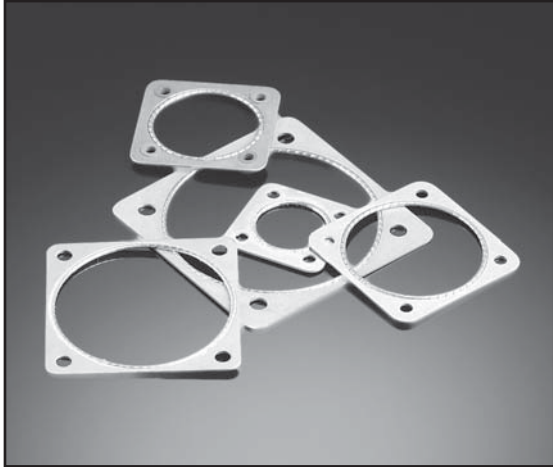

Aluminum Frame:

SSCG - B - _____

Dash No.
From Table

Grommets
-O: Without
-W: With

Optional Silicone or Fluorosilicone on a Stainless Steel Frame:

CS - T - _____ / _____

Dash No.
From Table

Gasket Plating
T: Tin
E: Edge
IW: RoHS
EIW: RoHS
Edge

Elastomeric Sealing
/S: Silicone
/F: Fluorosilicone

*-W (with grommet) not available

Outer Conductive Spiral:
Tin/Lead Plated Beryllium Copper



Resilient Inner Core:
Solid Silicone (**SSCG only**)

Dash No.	For Use with Connectors				A ±.005"	B +.010" -.005"	C ±.020"	D ±.005"
	MIL-C-26482, 26500, 83723 Series 1 & 3 NAS 1599 "B" & "T" Size	MIL-C-38999		MIL-C-81703 Size				
		1 & 2 Size	3 & 4 Size					
01*	8	8			.594"	.562"	.937"	.125"
02				3	.625"	.623"	1.000"	.125"
03	10	9 & 10	9	7	.791"	.687"	1.062"	.125"
04*					.798"	.883"	1.200"	.125"
05	12	11 & 12	10 & 11		.812"	.812"	1.156"	.125"
06				12	.812"	.828"	1.200"	.125"
07	14	13 & 14	12 & 13	19	.906"	.947"	1.200"	.125"
08*					.928"	1.070"	1.345"	.125"
09	16	15 & 16	14 & 15	27	.969"	1.063"	1.375"	.125"
10*					.978"	1.133"	1.437"	.125"
11	18	17 & 18	16 & 17		1.062"	1.187"	1.437"	.125"
12*					1.140"	1.325"	1.625"	.125"
13				37	1.187"	1.325"	1.562"	.125"
14	20	19 & 20	18 & 19		1.156"	1.312"	1.563"	.125"
15*					1.128"	1.508"	1.825"	.125"
16	22		20 & 21		1.250"	1.437"	1.687"	.125"
17	24		22 & 23		1.375"	1.562"	1.825"	.152"
18					1.392"	1.633"	1.937"	.152"
19				61	1.436"	1.570"	1.825"	.152"
20		25	24 & 25		1.500"	1.682"	1.937"	.152"
21					1.568"	1.830"	2.250"	.152"
22					1.716"	2.030"	2.375"	.173"
23					.753"	.771"	1.100"	.125"
28	32				1.750"	2.062"	2.312"	.173"
29*					1.062"	1.250"	1.437"	.125"
32					1.938"	2.186"	2.550"	.173"
33			24 & 25		1.500"	1.682"	1.830"	.152"
34	36				1.938"	2.312"	2.600"	.173"
35					1.750"	1.846"	2.250"	.173"



Application Information

Connector-Seal gaskets are made by attaching a spiral gasket to a retaining frame. The retaining frame provides a positive stop and holds the gasket material in place to provide an EMI seal and prevent deformation of the material.

When choosing a gasket, select an inside diameter that easily clears the connector barrel. The shielding is achieved by making contact between the two joint surfaces, not by touching the barrel. Choose between the SSCG or CS series depending on your application and desired retaining frame material.

Materials

See page 55 for material specifications.

SSCG Frame: Chem-film plated aluminum.

SSCG Spiral: Enduro-Shield moderate force tin/lead plated beryllium copper.

SSCG Core: Cured silicone adhesive. **Grommets:** Solid silicone rubber.

CS Frame: Silicone or Fluorosilicone sealing over a stainless steel frame.

CS Spiral: Spira-Shield standard force tin/lead plated beryllium copper.

(See *Options* for RoHS compliance).

Shielding Quality

EMI Connector-Seal gaskets offer shielding quality from 116 to 152 dB. The shielding quality may vary depending on your specific application. Refer to Shielding Quality for more complete performance data.

Compression Force

Optimal compression of the gasket is 25% of the diameter of the spiral. The compression force stated is approximate. When installing the gasket, care must be taken to clear the mounting pins one at a time.

SSCG Series: ~10 pounds per linear inch compression force required.

CS Series: ~30 pounds per linear inch compression force required.

Available Options

Plating

See page 56 for material compatibility information.

The gasket is electroplated, 90% tin, 10% lead per AMS-P-81728 (edges unplated). Plating options can be specified by adding a prefix before the part number:

E: Edge tin/lead plating (includes edges) for high humidity or salt-fog environments

IW: RoHS compliant tin plating (Example: **IWSSCG-B-21-O**)

EIW: RoHS compliant edge tin plating for high humidity or salt-fog

SSCG Core Material

The SSCG uses a Spira-Seal gasket with a standard core of solid silicone adhesive. A special core can be specified by adding an option to the end of the part number:

-F: Fluorosilicone (Example: **SSCG-B-21-O-F**)

-O: Silicone that meets outgassing requirements

-Z: Silicone which is a non-acetic acid adhesive (per MIL-A-46146)

Frame

Specify frame and other options by choosing the desired prefix from the table.

Example:

CS-E-14 /S

EMI Connector-Seal

Edge tin/lead plated

gasket, Silicone frame

An alternate frame is available including stainless steel sealed on both sides by silicone or fluorosilicone elastomeric material. This is still **EMI-only protection** due to the sizing. Please see the next page for environmental sealing if required.

Frame	Options	Tin/Lead Plated Gasket	RoHS Tin Plated Gasket	Edge Tin/Lead Plated Gasket	RoHS Edge Tin Plated Gasket
Chem-Film Aluminum	With Grommet	SSCG-B-__-W	IWSSCG-B-__-W	ESSCG-B-__-W	EIWSSCG-B-__-W
	No Grommet	SSCG-B-__-O	IWSSCG-B-__-O	ESSCG-B-__-O	EIWSSCG-B-__-O
Elastomeric Frame Material	Silicone	CS-T-__ /S	CS-IW-__ /S	CS-E-__ /S	CS-EIW-__ /S
	Fluorosilicone	CS-T-__ /F	CS-IW-__ /F	CS-E-__ /F	CS-EIW-__ /F

Specify dash number from table on page 21.

